

MODEL NUMBER	HHI100-12-444T		
HORSEPOWER	100		
RPM / POLES	1200 / 6		
VOLTAGE / PHASE	230 / 460 V / 3		
FRAME	444T		
ENCLOSURE / DEGREE OF PROTECTION	TEFC / IP55		
FREQUENCY	60 HZ		
FULL LOAD SPEED	1185 RPM		
SERVICE FACTOR	1.15 SF at 40° C / 1.0 SF at 65° C		
INSULATION CLASS	F Class N Varnish		
FULL LOAD AMPS; 230 / 460	233.1 / 116.6 A Usable On 208 V At 258 A		
LOCKED ROTOR CURRENT (% Full Load)	680 / 680 %		
NEMA CODE LETTER	G		
EFFICIENCY / POWER FACTOR	<u>LOAD</u>	<u>EFF.</u>	<u>P.F.</u>
	100 %	95.0 %	85.0 %
	75 %	95.2 %	81.4 %
	50 %	94.9 %	72.6 %
DUTY CYCLE	S1 / Continuous		
TORQUE	<u>FULL LOAD</u>	<u>LRT</u>	<u>BDT</u>
	445.9 lb.ft.	140 %	220 %
NEMA DESIGN	B		
MOMENT OF INERTIA	<u>LOAD (Max.)</u>	<u>MOTOR</u>	
	3008.432 lb.ft. ²	73.410 lb.ft. ²	
SOUND PRESSURE LEVEL (No Load 1 M From Motor)	78 dB(A)		
NUMBER OF STARTS (Hot / Cold)	2 Hot / 3 Cold		
MAX. AMBIENT TEMPERATURE	40° C at 1.15 SF / 65° C at 1.0 SF		
MAX. ELEVATION	3300 Ft. Above Sea Level		
TEMPERATURE RISE (At Full Load)	80° C		
DRIVE-END BEARING	NU318		
OPPOSITE DRIVE-END BEARING	6316C3		
GREASE TYPE	Mobil Polyrex EM		
MOUNTING	F1 (F2 Suitable), W6, W8, B3, V5, V6		
ROTATION	Bi-Directional		
APPROXIMATE WEIGHT	1530 lbs.		
AREA CLASSIFICATION	Class I, Division 2, Groups A, B, C, D		
INVERTER RATING	10:1 CT / 20:1 VT - Meets NEMA MG1 Part 31		
SPECIFICATION - In Accordance With	NEMA, CSA		



CC 038A



본 도면은 현대중공업(주) 재산이므로
허가없이 복사할 수 없음 (추첨유위)

THIS DRAWING IS PROPRIETARY TO HEECO. NO PART OF THIS DRAWING
MAYBE REPRODUCED WITHOUT THE PERMISSION OF HHI.

HYUNDAI HEAVY INDUSTRIES CO., LTD.		T E F C		TYPE	LP, JP
		THREE PHASE INDUCTION MOTOR			Cast iron frame
FRAME SIZE	OUTPUT(HP)	POLES	Hz	TIME RATING	
444T-4,6P			60	CONT	

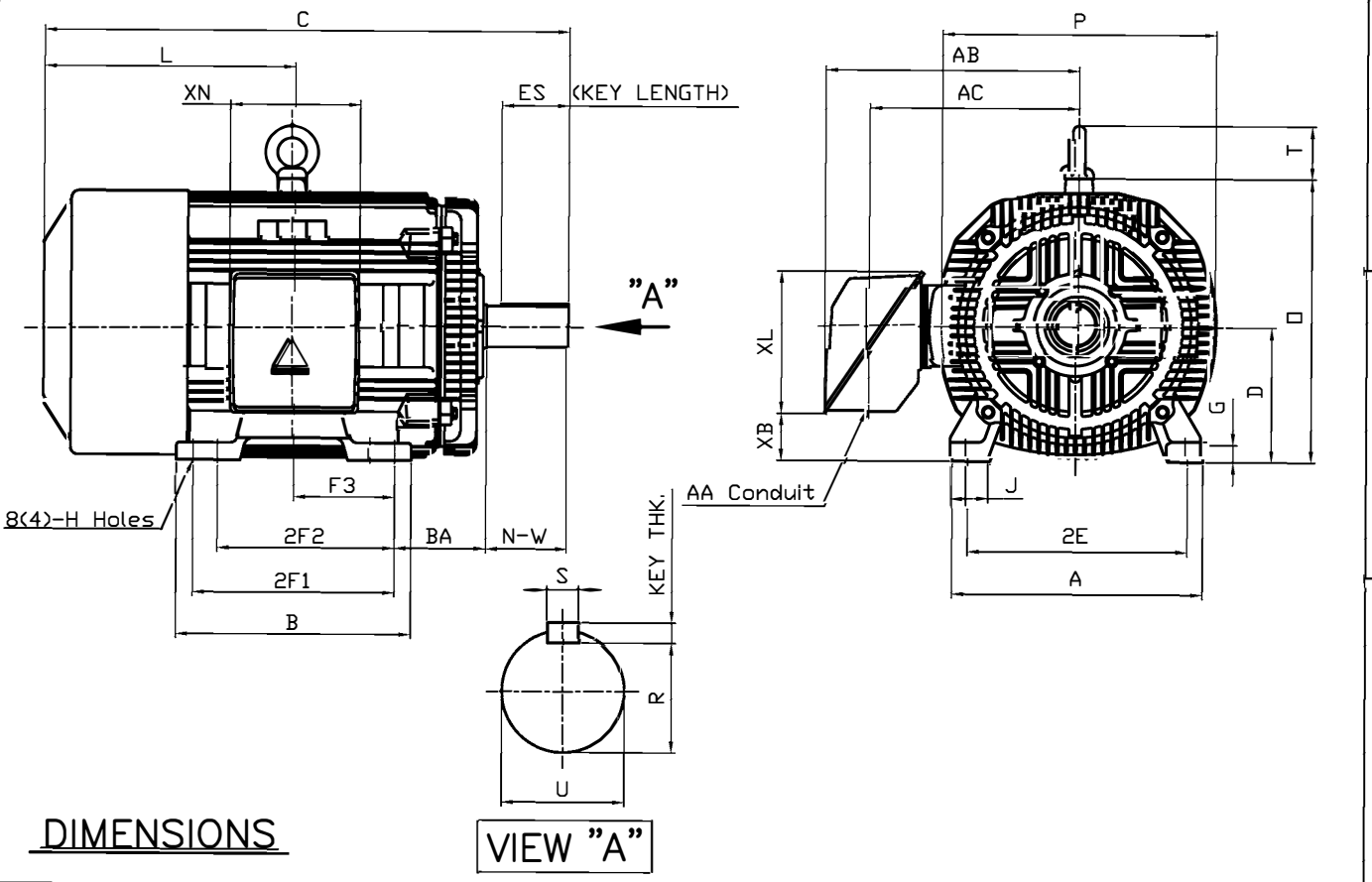

DIMENSIONS

VIEW "A"

M O U N T I N G									C O N D U I T B O X					APPROX. WGT.(LB)	
A	B	2E	2F1	2F2	F3	G	J	H	AA	AB	AC	XB	XL		XN
20.51	19.21	18.00	(16.50)	14.50	8.248	1.42	3.07	0.81	3.00	21.26	18.03	3.83	11.65	10.63	1530

O V E R A L L							S H A F T				KEY	BEARING		
BA	C	D	L	O	P	T	U	N-W	KEYWAY			THK.	DRIVE END	OPP. DRIVE END
									R	ES	S			
7.50	45.21	11.00	20.96	23.19	22.40	4.33	3.375	8.50	2.880	6.93	0.875	0.875	6318C3 or NU318	6316C3

NOTE

1. Dimension "D" tolerance : +0.00inch - 0.03inch (143T-365T) ; +0.000inch - 0.06inch (404T-449T)
2. Dimension "U" tolerance : +0.000inch - 0.005inch (143T-215T), +0.000inch - 0.001inch (254T-449T)
3. Dimension "R" tolerance : +0.000inch - 0.015inch

Q'TY	DESCRIPTION	MATERI AL	DIMENSION	WEIGHT	PART NO.	REMARK	NO.
APPD BY	K.J. Kang	UNIT	INCH	SUBJECT	444T	CAD PROJ	FILE
Q.P CHK		SCALE	N/S	TITLE	MMSTDMTR\A1117AA		
CHKD BY		PROJEC'N	3 각법(3rd Angle)	OUTLINE			
DSND BY	N.D.Lee	DATE	2011.01.12	REF. NO	A1117AA	Sheet No.	of



PERFORMANCE CURVE

CURVE NO.

P-PLP444SR06

Type	: PLP
Full Load Torque	: 445.9 lb.ft
Motor moment of Inertia (J)	: 73.410 lb.ft ²
Load moment of Inertia (J)	: 3008.432 lb.ft ²

75 kW	100 HP	60 Hz	
6 P	Rated Speed	: 1185 RPM	
Rated Voltage	575V	460V	230V
Full Load Current	93.3A	116.6A	233.1A

SPEED VS TORQUE & CURRENT CURVE

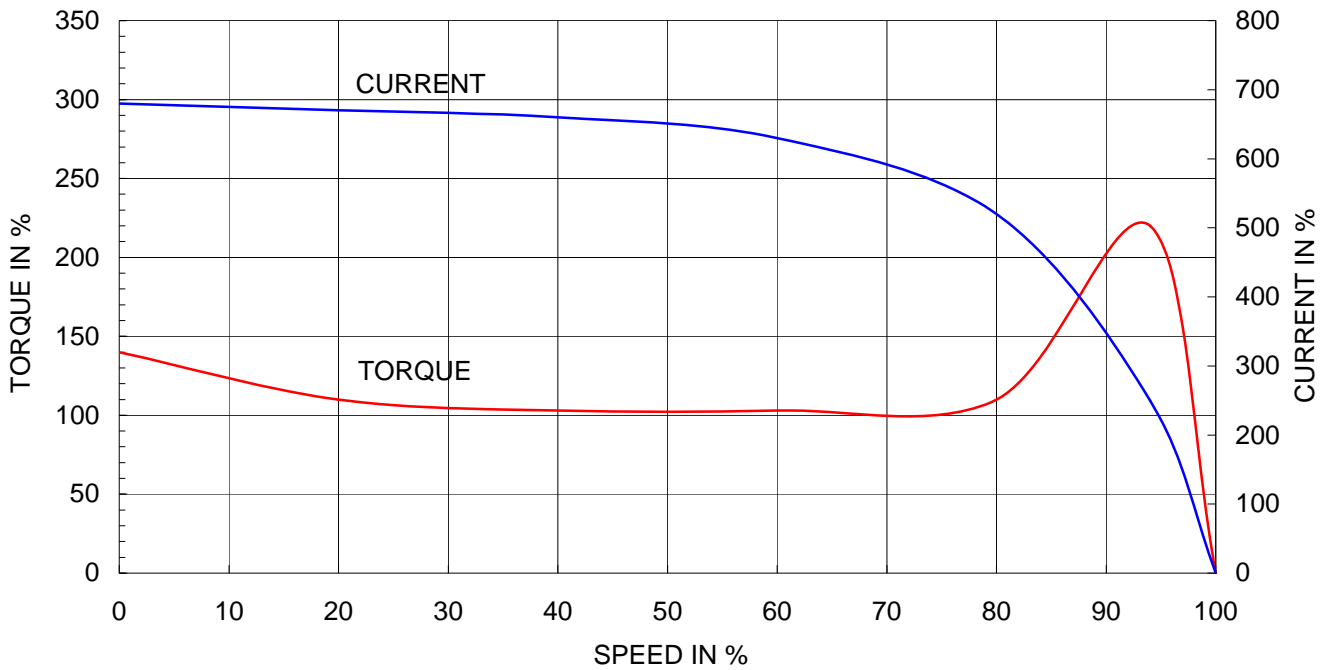

OUTPUT VS EFF., P.F & CURRENT CURVE

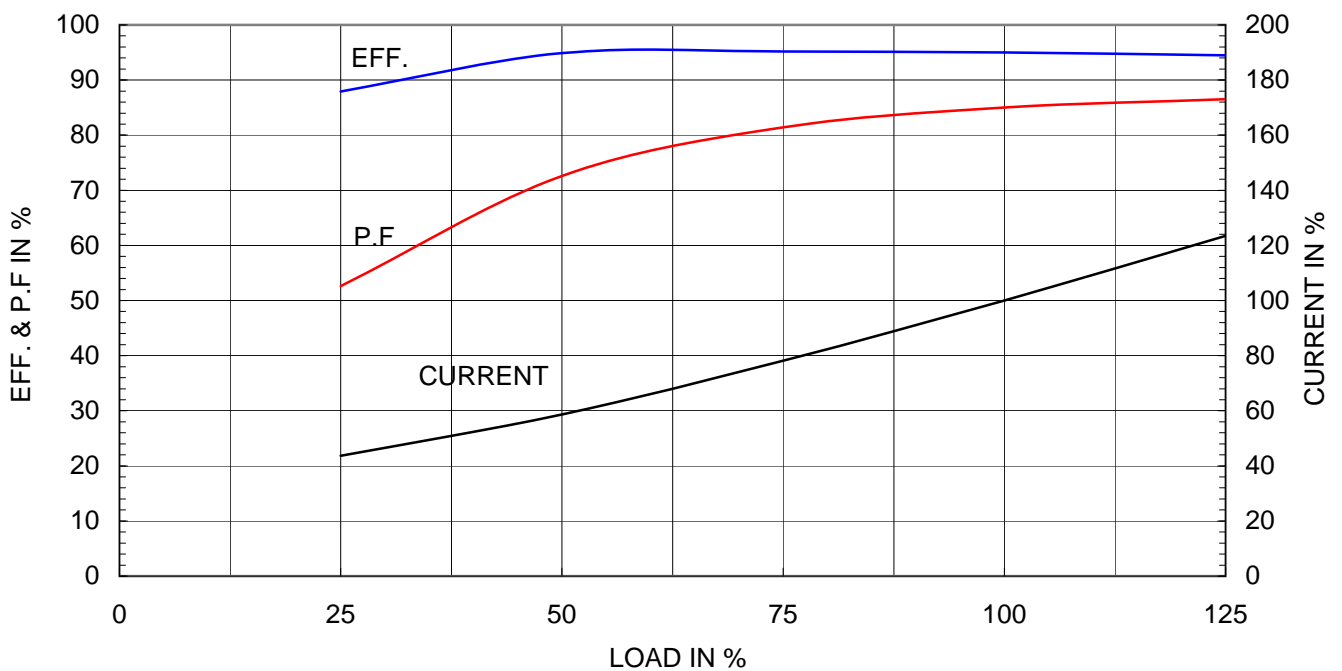



THERMAL LIMIT & TIME CURRENT CURVE

CURVE NO.

T-PLP100-12-444T

Type :	PLP100-12-444T	
FULL LOAD TORQUE :	445.9	lb.ft
J OF LOAD :	-	lb.ft ²
J OF MOTOR :	73.4	lb.ft ²

100	HP	6	P	60	Hz
RATED SPEED :		1185 rpm			
VOLTAGE		460 V	575 V		
RATED CURRENT		116.6A	93.3A		

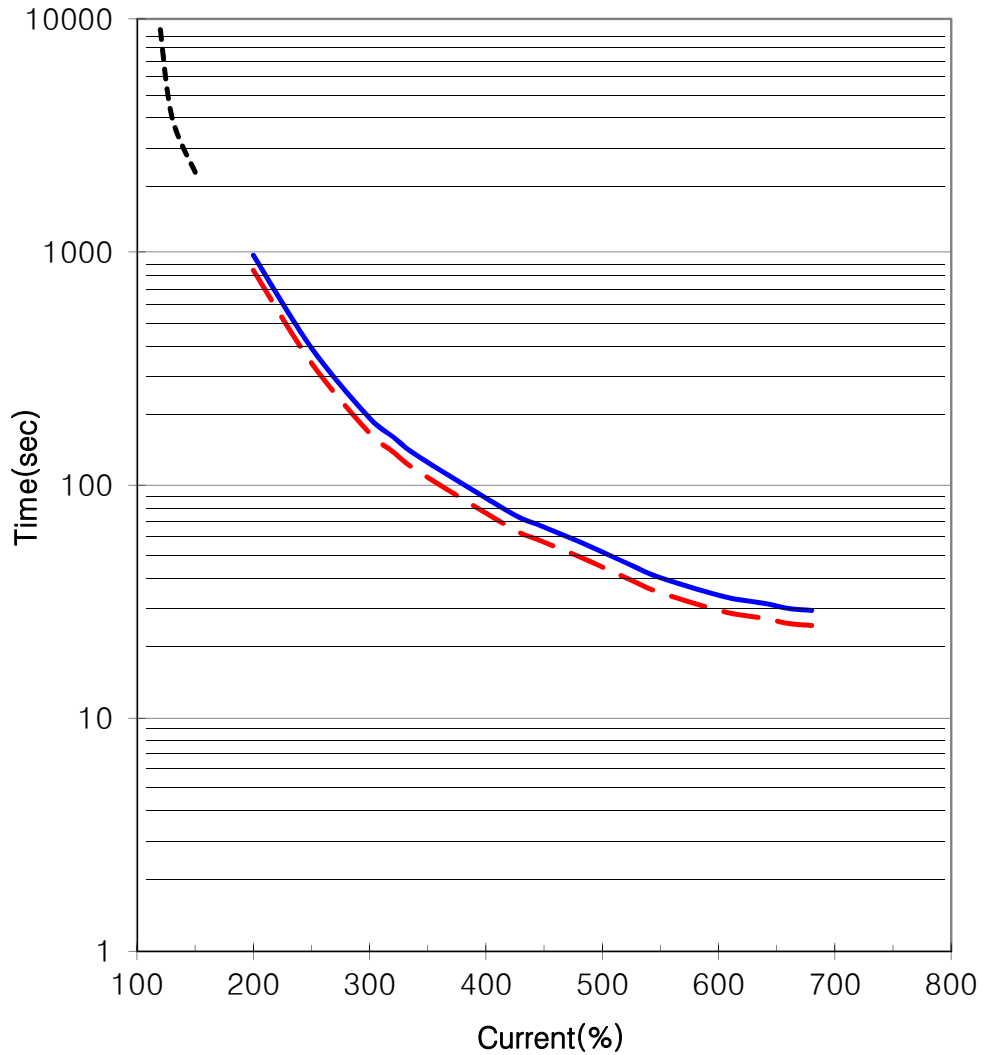

— THERMAL LIMIT CURVE AT COLD CONDITION
- - THERMAL LIMIT CURVE AT HOT CONDITION

STARTING TIME	SAFE STALL TIME
- at rated voltage starting	25 sec. at Hot condition
- at 80% of rated voltage starting	29 sec. at Cold condition

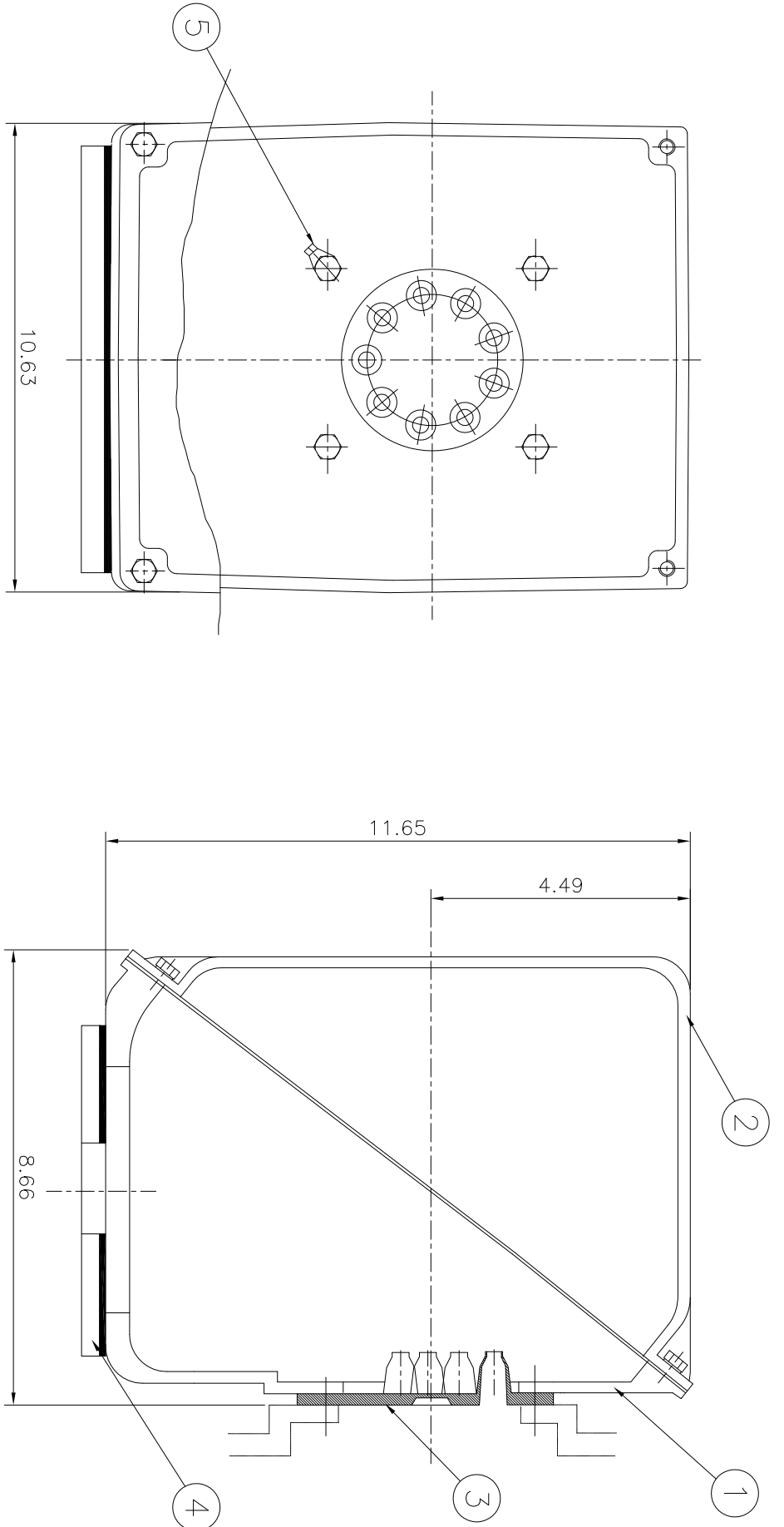

REV	DATE	CONTENTS	REVD BY	CHKD BY	CHKD BY	APPD BY																														
1																																				
<table border="1" style="width:100%; border-collapse: collapse;"> <tr> <td style="width: 15%;">구분</td> <td style="width: 15%;">구분</td> <td style="width: 15%;">구분</td> <td style="width: 15%;">구분</td> <td style="width: 15%;">구분</td> <td style="width: 15%;">구분</td> </tr> <tr> <td>1-4</td> <td>±0.1</td> <td>6-30</td> <td>±0.5</td> <td>1-4</td> <td>±0.1</td> </tr> <tr> <td>4-18</td> <td>±0.2</td> <td>30-120</td> <td>±0.8</td> <td>18-63</td> <td>±0.3</td> </tr> <tr> <td>18-63</td> <td>±0.5</td> <td>120-315</td> <td>±1.2</td> <td>63-250</td> <td>±0.8</td> </tr> <tr> <td>63-250</td> <td>±0.8</td> <td>315-1000</td> <td>±2.0</td> <td>1000-</td> <td>±3.0</td> </tr> </table>							구분	구분	구분	구분	구분	구분	1-4	±0.1	6-30	±0.5	1-4	±0.1	4-18	±0.2	30-120	±0.8	18-63	±0.3	18-63	±0.5	120-315	±1.2	63-250	±0.8	63-250	±0.8	315-1000	±2.0	1000-	±3.0
구분	구분	구분	구분	구분	구분																															
1-4	±0.1	6-30	±0.5	1-4	±0.1																															
4-18	±0.2	30-120	±0.8	18-63	±0.3																															
18-63	±0.5	120-315	±1.2	63-250	±0.8																															
63-250	±0.8	315-1000	±2.0	1000-	±3.0																															

Q'TY	DESCRIPTION	MATERIAL	DIMENSION	WEIGHT	PART NO.	REMARK	NO.
1	EARTH TERMINAL LUG						5
1	CABLE ENTRY PLATE						4
1	GASKET	NBR					3
1	TERMINAL BOX COVER	CAST IRON					2
1	TERMINAL BOX BODY	CAST IRON					1

APPD BY	KANG KEONG JUNG	UNIT	INCH	Non Scale
CHKD BY	KIM JIN HONG	SCALE	32° (3rd Angle)	
CHKD BY	KIM OK JIN	PROJEC'N	2011-10-21	
DSND BY	KIM RYANG GYU	DATE	2011-10-21	

TITLE	Main Terminal Box Assembly	
SUBJECT	NEMA 400, 440	DWG SIZE
DWG NO	3M-016882	AS (1:1)
REF. NO		
DWG NO	3M-016882	
Sheet No.	of	Revision No.
0		0