

|  |  |                           |             |
|--|--|---------------------------|-------------|
| MODEL NUMBER                                   | HHI30-36-575-286TS                         |                           |             |
| HORSEPOWER                                     | 30   |                           |             |
| RPM / POLES                                    | 3600 / 2                                   |                           |             |
| VOLTAGE / PHASE                                | 575 V / 3                                  |                           |             |
| FRAME  | 286TS                                      |                           |             |
| ENCLOSURE / DEGREE OF PROTECTION               | TEFC / IP55                                |                           |             |
| FREQUENCY                                      | 60 HZ                                      |                           |             |
| FULL LOAD SPEED                                | 3560 RPM                                   |                           |             |
| SERVICE FACTOR                                 | 1.15 SF at 40° C / 1.0 SF at 65° C         |                           |             |
| INSULATION CLASS                               | F Class N Varnish                          |                           |             |
| FULL LOAD AMPS; 575                            | 27.0 A                                     |                           |             |
| LOCKED ROTOR CURRENT (% Full Load)             | 700 %                                      |                           |             |
| NEMA CODE LETTER                               | G  |                           |             |
| EFFICIENCY / POWER FACTOR                      | <u>LOAD</u>                                | <u>EFF.</u>               | <u>P.F.</u> |
|  | 100 %                                      | 91.7 %                    | 89.0 %      |
|  | 75 %                                       | 91.7 %                    | 87.8 %      |
|  | 50 %                                       | 90.0 %                    | 84.5 %      |
| DUTY CYCLE                                     | S1 / Continuous                            |                           |             |
| TORQUE   | <u>FULL LOAD</u>                           | <u>LRT</u>                | <u>BDT</u>  |
|  | 43.5 lb.ft.                                | 160 %                     | 230 %       |
| NEMA DESIGN                                    | B  |                           |             |
| MOMENT OF INERTIA                              | <u>LOAD (Max.)</u>                         | <u>MOTOR</u>              |             |
|  | 67.632 lb.ft. <sup>2</sup>                 | 2.089 lb.ft. <sup>2</sup> |             |
| SOUND PRESSURE LEVEL ( No Load 1 M From Motor) | 86 dB(A)                                   |                           |             |
| NUMBER OF STARTS (Hot / Cold)                  | 2 Hot / 3 Cold                             |                           |             |
| MAX. AMBIENT TEMPERATURE                       | 40° C at 1.15 SF / 65° C at 1.0 SF         |                           |             |
| MAX. ELEVATION                                 | 3300 Ft. Above Sea Level                   |                           |             |
| TEMPERATURE RISE (At Full Load)                | 80° C                                      |                           |             |
| DRIVE-END BEARING                              | 6310ZC3                                    |                           |             |
| OPPOSITE DRIVE-END BEARING                     | 6310ZC3                                    |                           |             |
| GREASE TYPE                                    | Mobil Polyrex EM                           |                           |             |
| MOUNTING                                       | F1 (F2 Suitable), W6, W8, B3, V5, V6       |                           |             |
| ROTATION                                       | Bi-Directional                             |                           |             |
| APPROXIMATE WEIGHT                             | 410 lbs.                                   |                           |             |
| AREA CLASSIFICATION                            | Class I, Division 2, Groups A, B, C, D     |                           |             |
| INVERTER RATING                                | 10:1 CT / 20:1 VT - Meets NEMA MG1 Part 31 |                           |             |
| SPECIFICATION - In Accordance With             | NEMA, CSA                                  |                           |             |



CC 038A





# TEFC

**THREE PHASE INDUCTION MOTOR**

**TYPE**

LP, JP

CAST IRON FRAME

FRAME SIZE

OUTPUT(HP)

POLES

Hz

TIME RATING

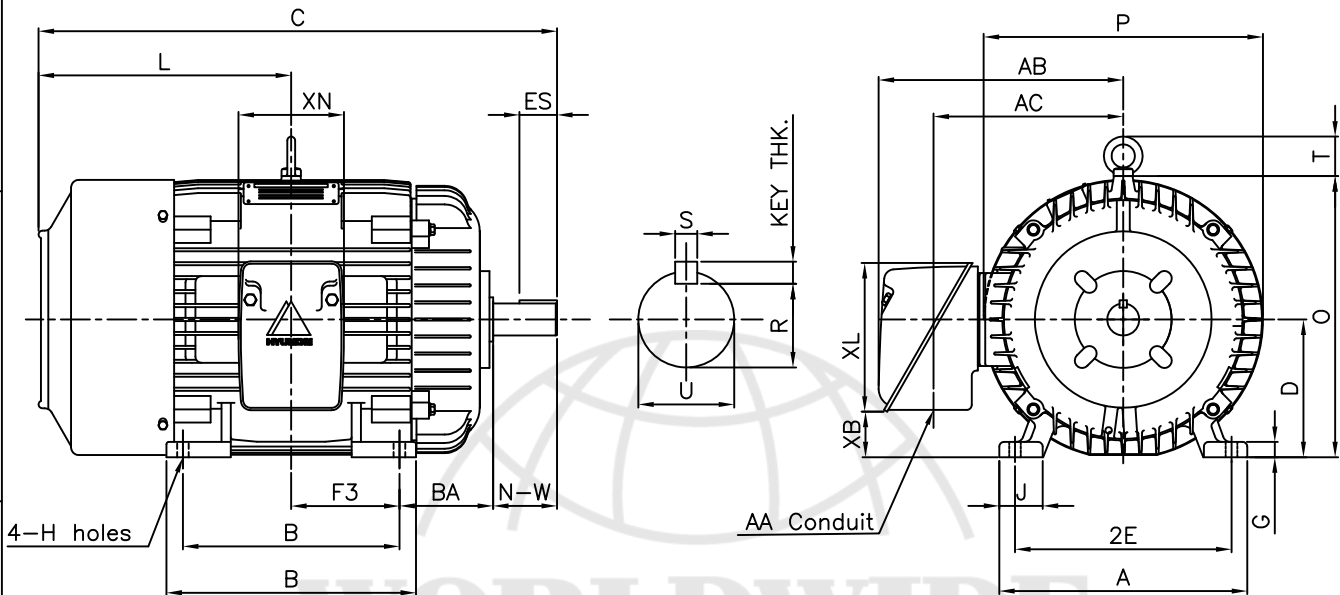

## DIMENSIONS

| M O U N T I N G |       |       |       |     |      |      |      |      | C O N D U I T B O X |       |      |      |      |      | APPROX. WGT.(LB) |
|-----------------|-------|-------|-------|-----|------|------|------|------|---------------------|-------|------|------|------|------|------------------|
| A               | B     | 2E    | 2F1   | 2F2 | F3   | G    | J    | H    | AA                  | AB    | AC   | XB   | XL   | XN   | 286T             |
| 12.60           | 12.68 | 11.00 | 11.00 | -   | 5.50 | 0.78 | 2.20 | 0.53 | 1.50                | 12.43 | 9.64 | 3.42 | 7.56 | 6.61 | 410              |

| O V E R A L L |       |      |       |       |       |      | S H A F T |      |        |      |       | KEY THK. | B E A R I N G |                |
|---------------|-------|------|-------|-------|-------|------|-----------|------|--------|------|-------|----------|---------------|----------------|
| BA            | C     | D    | L     | O     | P     | T    | U         | N-W  | KEYWAY |      |       |          | DRIVE END     | OPP. DRIVE END |
|               |       |      |       |       |       |      |           |      | R      | ES   | S     |          |               |                |
| 4.75          | 26.34 | 7.00 | 12.84 | 14.28 | 14.19 | 2.01 | 1.625     | 3.25 | 1.416  | 1.91 | 0.375 | 0.375    | 6310ZC3       | 6310ZC3        |

**NOTE**

- 1.Dimension "D" tolerance : +0.00inch - 0.03inch
- 2.Dimension "U" tolerance : +0.000inch - 0.001inch
- 3.Dimension "R" tolerance : +0.000inch - 0.015inch

|         |            |          |            |                         |            |                                    |
|---------|------------|----------|------------|-------------------------|------------|------------------------------------|
| APPD BY | J. H. KIM  | UNIT     | INCH       | SUBJECT                 | NEMA 286TS | CAD PROJ \ FILE<br>XSMOUTN\A1110BA |
| CHKD BY | K. S. LEE  | SCALE    | 1/10       |                         |            |                                    |
| CHKD BY |            | PROJEC'N | 3rd Angle  | TITLE<br><b>OUTLINE</b> |            |                                    |
| DSND BY | KIM IN KYU | DATE     | 2010.12.31 |                         |            |                                    |
|         |            |          |            | REF. NO                 | A1110BA    | Sheet No. of                       |
|         |            |          |            | DWG NO                  | 350A1110BA | Revision No. 0                     |

|                               |                           |
|-------------------------------|---------------------------|
| Type :                        | PLP                       |
| Full Load Torque :            | 43.5 lb.ft                |
| Motor moment of Inertia (J) : | 2.089 lb.ft <sup>2</sup>  |
| Load moment of Inertia (J) :  | 67.632 lb.ft <sup>2</sup> |

|                   |               |          |       |
|-------------------|---------------|----------|-------|
| 22 kW             | 30 HP         | 60 Hz    |       |
| 2 P               | Rated Speed : | 3560 RPM |       |
| Rated Voltage     | 575V          | 460V     | 230V  |
| Full Load Current | 27.0A         | 33.8A    | 67.6A |

SPEED VS TORQUE & CURRENT CURVE

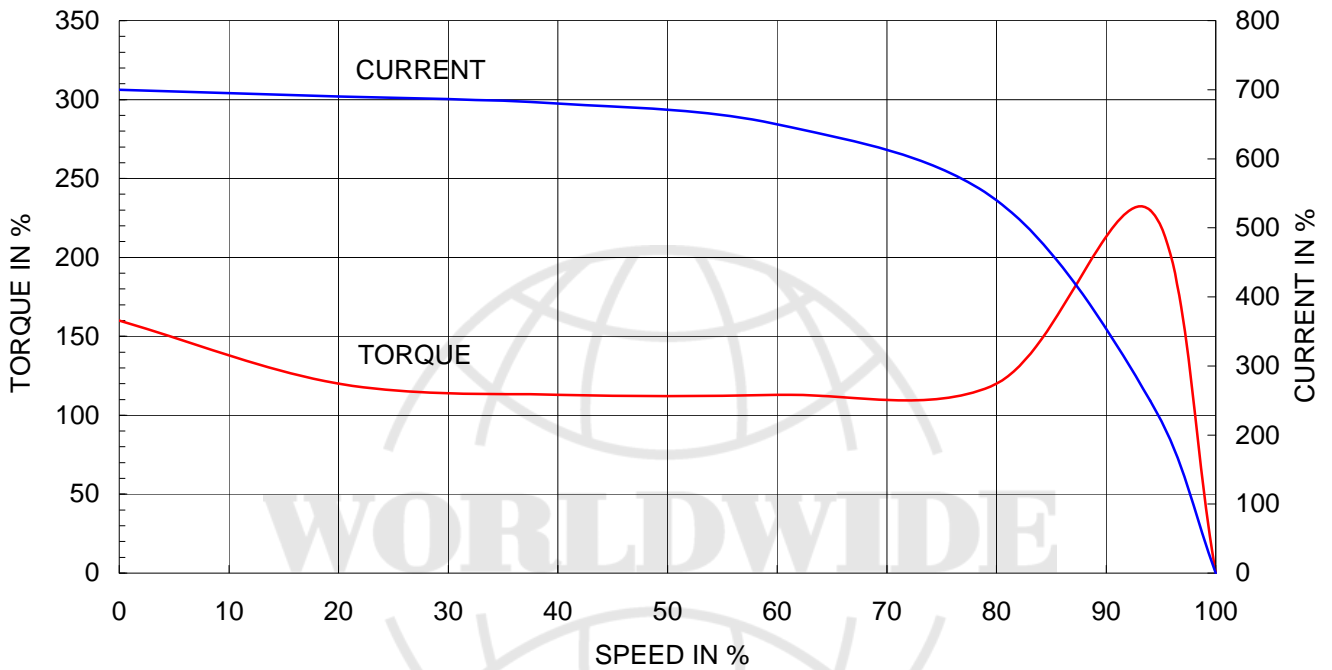

OUTPUT VS EFF., P.F & CURRENT CURVE

