

DATA SHEET

Premium Efficiency Motor: **SSPE1.5-36-143TCRD,**

60 Hz

WorldWide Electric Corporation

1 (800) 808-2131

Worldwideelectric.net



Document Generated: 9-Nov-2020

Document ID:

Customer:

MOTOR INFORMATION

HP	1.5
RPM	3600
Phase	3
Frequency	60
Voltage	230/460
Frame Size	143TC
Enclosure	TEFC
Degree of Protection	IP66
Service Factor	1.15
Poles	2
Full Load Speed	3480
Insulation Class	F
Temp Rise	80°C
NEMA Code Letter	M
Duty Cycle	S1
Slip	3.33%
NEMA Design	B
Moment of Inertia	0.072 lb.ft.^2
Locked Rotor Time (Hot)	12 seconds
Sound Pressure Level	76 dB(A)
Number of Starts	10
Max Ambient Temperature	40° C
Max Elevation	1000 m.a.s.l (3300 f.a.s.l)
Mounting	F1
Rotation	Bidirectional
Area of Classification	Div.2 Class I, Gr. A,B,C&D T2B
Inverter Rating	10:1 CT/20:1 VT
Standard	NEMA MG1, UL1004
Approvals	CSA,UL,CE

EFFICIENCY/POWER FACTOR

LOAD	EFF	P. F.
100%	86.5 %	0.91
75%	78.0 %	0.82
50%	74.0 %	0.73

TORQUE

FULL LOAD	LRT	BDT
2.3 lb.ft.	285 %	300 %

AMPERAGE INFORMATION

	230V	460V
Full Load Amps	4A	2
Locked Rotor Amps	40A	20A
No Load Current	1.5A	0.75A
Usable at 208V	4.2 A	

BEARING INFORMATION

DE Bearing	6205 2RS
ODE Bearing	6205 2RS
Grease Type	Mobil Polyrex EM
DE Regreasing Interval	-- Hours
ODE Regreasing Interval	-- Hours
Grease Quantity	--

ADDITIONAL DATA

F2 Suitable	No
Shaft Material	304 Stainless Steel
Connection Diagram	9 Lead 2Y/Y
Approximate Weight	38 lbs.

REVISED 10/21/2020

MOTOR DRAWING

Premium Efficiency Motor: **SSPE1.5-36-143TCRD**

WorldWide Electric Corporation

1 (800) 808-2131

Worldwideelectric.net

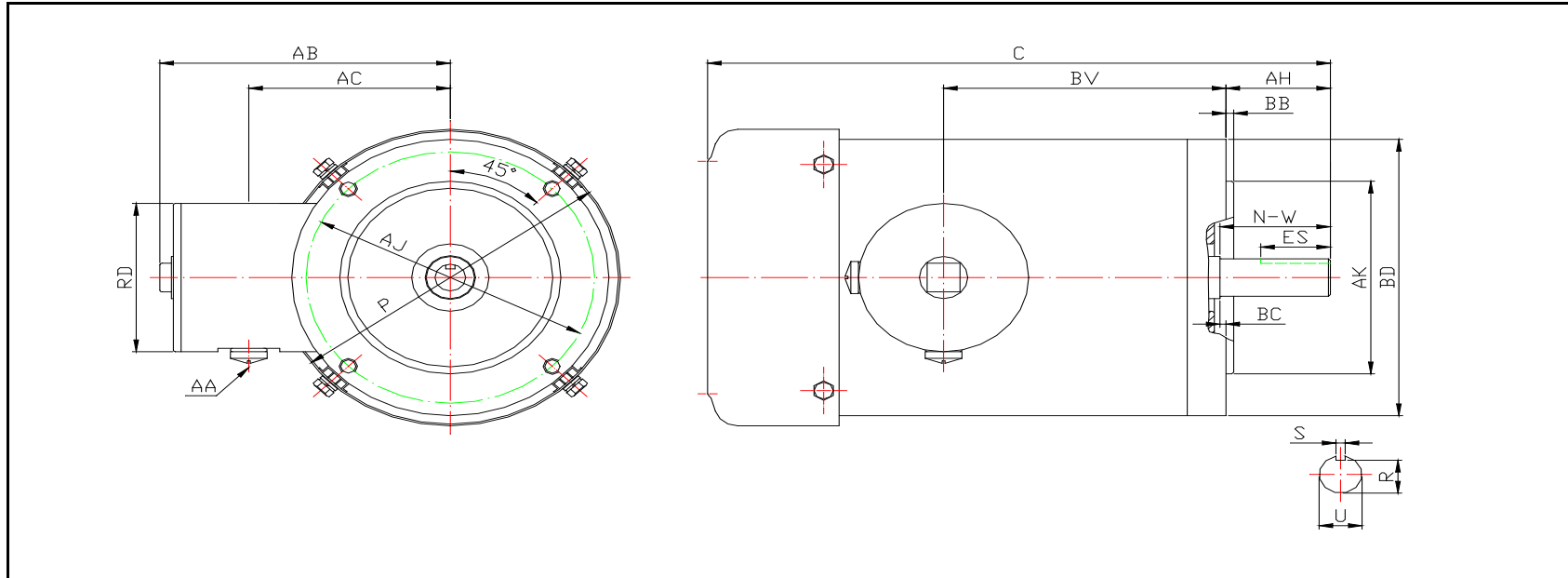

DIMENSION - INCHES

MOUNTING						A	B	C	D	G	P	O	T
E	2E	2F1	2F2	H	BA								
N/A	N/A	N/A	N/A	N/A	N/A	N/A	N/A	12.63	N/A	N/A	6.95	N/A	N/A

AB	BC	KEY		KEYSET	SHAFT			TERMINAL BOX				
		S	ES	R	AH	N-W	U	AA	AB	AC	RD	BV
5.95	0.12	0.188	1.41	0.771	2.12	1.88	0.875	1/2	5.95	4.5	3.45	4.75

FLANGE				
AJ	AK	BB	BD	BF
5.875	4.5	0.16	6.45	4*3/8-16

REV.	SUMMARY OF MODIFICATIONS	DATE
0		10/21/2020

PERFORMANCE CURVES

WorldWide Electric Corporation

1 (800) 808-2131

Worldwideelectric.net



Premium Efficiency Motor:

SSPE1.5-36-143TCRD

Document Generated: 9-Nov-2020
Document ID:

Customer:

Motor Type	SSPE		FL Speed	3480	
Output Rating (HP)	1.5		LRT (%FLT)	285	
Full Load Torque	2.3	lb.ft	460 volt FLA	2	
Rotor Wk^2	0.072	lb-ft^2	230 volt FLA	4A	
			BDT (%FLT)	300	

SPEED VS TORQUE & CURRENT CURVE

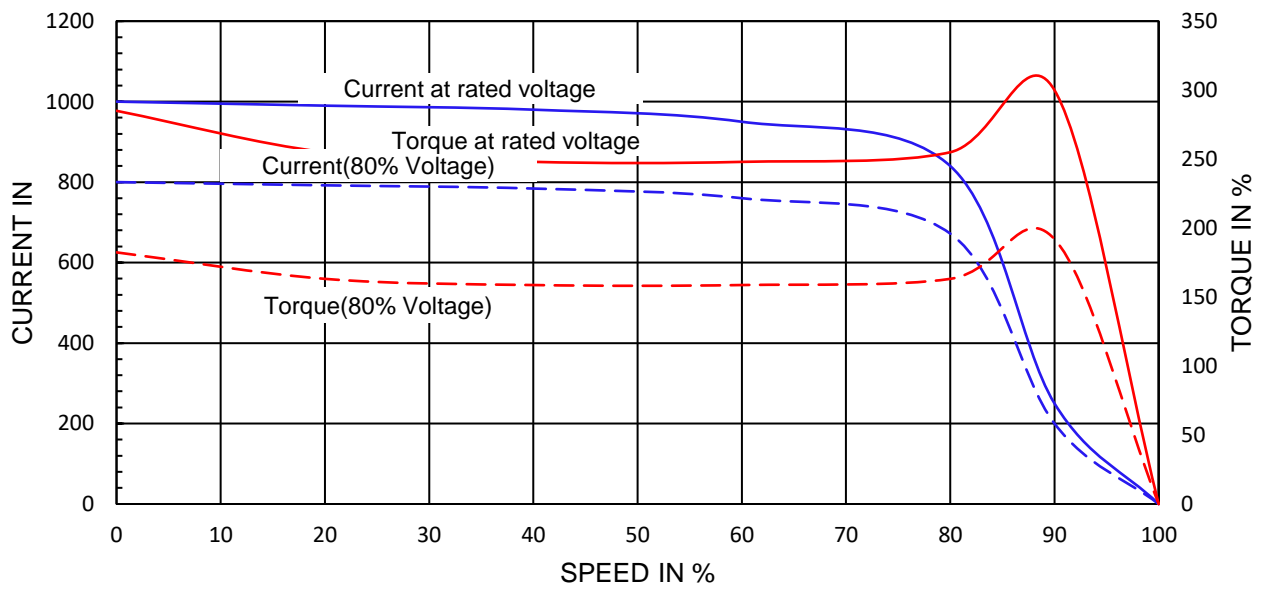

OUTPUT VS EFF., P.F. & CURRENT CURVE

