

# DATA SHEET

Premium Efficiency Motor: **SSPE5-18-184TC,**

**60 Hz**

WorldWide Electric Corporation

1 (800) 808-2131

Worldwideelectric.net



Document Generated: 9-Nov-2020  
Document ID:

Customer:

MOTOR INFORMATION	
HP	5
RPM	1800
Phase	3
Frequency	60
Voltage	230/460
Frame Size	184TC
Enclosure	TEFC
Degree of Protection	IP66
Service Factor	1.15
Poles	4
Full Load Speed	1765
Insulation Class	F
Temp Rise	80°C
NEMA Code Letter	J
Duty Cycle	S1
Slip	1.94%
NEMA Design	B
Moment of Inertia	0.5 lb.ft.^2
Locked Rotor Time (Hot)	12 seconds
Sound Pressure Level	64 dB(A)
Number of Starts	12
Max Ambient Temperature	40° C
Max Elevation	1000 m.a.s.l (3300 f.a.s.l)
Mounting	F1
Rotation	Bidirectional
Area of Classification	Div.2 Class I, Gr. A,B,C&D T2B
Inverter Rating	10:1 CT/20:1 VT
Standard	NEMA MG1, UL1004
Approvals	CSA,UL,CE

EFFICIENCY/POWER FACTOR		
LOAD	EFF	P. F.
100%	89.5 %	0.85
75%	90.0 %	0.77
50%	89.0 %	0.66

TORQUE		
FULL LOAD	LRT	BDT
14.7 lb.ft.	225 %	280 %

AMPERAGE INFORMATION		
	230V	460V
Full Load Amps	12.5A	6.25
Locked Rotor Amps	92A	46A
No Load Current	6A	3A
Usable at 208V	13 A	

BEARING INFORMATION	
DE Bearing	6308 2RS
ODE Bearing	6306 2RS
Grease Type	Mobil Polyrex EM
DE Regreasing Interval	-- Hours
ODE Regreasing Interval	-- Hours
Grease Quantity	--

ADDITIONAL DATA	
F2 Suitable	No
Shaft Material	304 Stainless Steel
Connection Diagram	9 Lead 2Y/Y
Approximate Weight	100 lbs.

REVISED 10/21/2020

# MOTOR DRAWING

Premium Efficiency Motor: **SSPE5-18-184TC**

WorldWide Electric Corporation

1 (800) 808-2131

Worldwideelectric.net

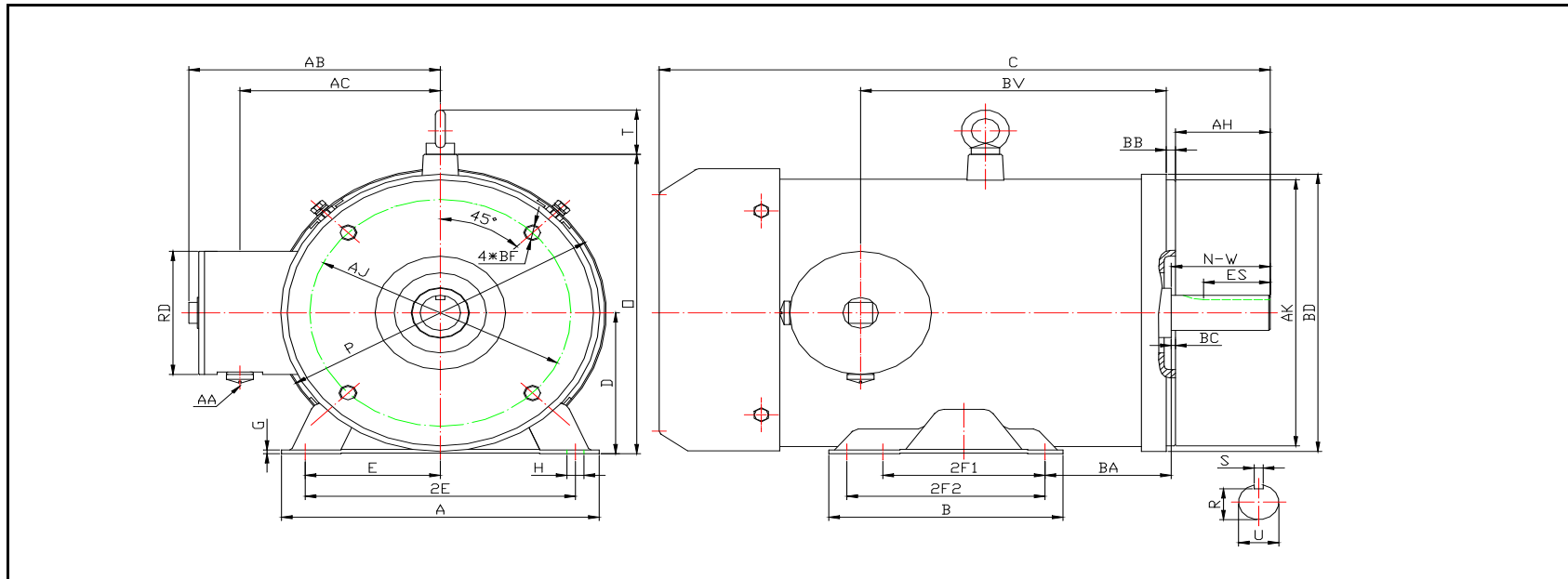

## DIMENSION - INCHES

MOUNTING						A	B	C	D	G	P	O	T
E	2E	2F1	2F2	H	BA								
3.75	7.5	4.5	5.5	0.71*0.47	3.5	8.8	6.5	17	4.5	0.118	9.25	9.55	1.45

AB	BC	KEY		KEYSET	SHAFT			TERMINAL BOX				
		S	ES	R	AH	N-W	U	AA	AB	AC	RD	BV
7	0.12	0.25	1.78	0.986	2.62	2.75	1.125	1/2	7	5.55	3.95	8.5

FLANGE				
AJ	AK	BB	BD	BF
7.25	8.5	0.25	8.85	4*1/2-13

REV.	SUMMARY OF MODIFICATIONS	DATE
0		10/21/2020

# PERFORMANCE CURVES

WorldWide Electric Corporation

1 (800) 808-2131

Worldwideelectric.net



Premium Efficiency Motor:

**SSPE5-18-184TC**

Document Generated: 9-Nov-2020  
Document ID:

Customer:

Motor Type	SSPE		FL Speed	1765	
Output Rating (HP)	5		LRT (%FLT)	225	
Full Load Torque	14.7	lb.ft	460 volt FLA	6.25	
Rotor Wk <sup>2</sup>	0.5	lb-ft <sup>2</sup>	230 volt FLA	12.5A	
			BDT (%FLT)	280	

SPEED VS TORQUE & CURRENT CURVE

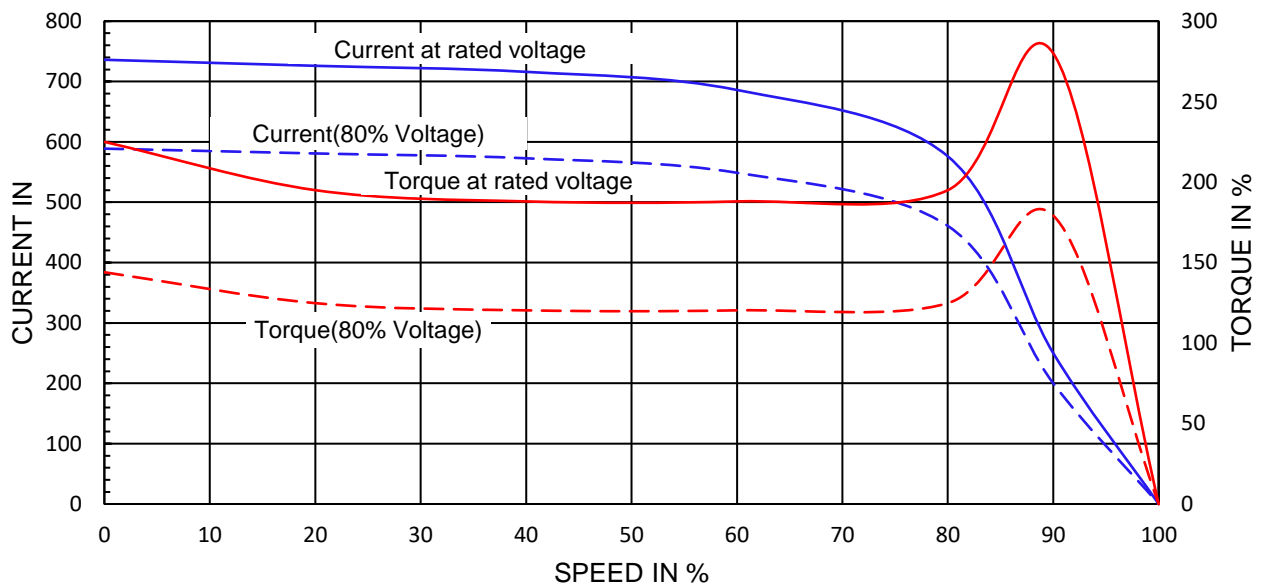

OUTPUT VS EFF., P.F. & CURRENT CURVE

